

INSTRUCTION – INSTALLATION OF B-03 SHORT EASY CLUTCH

Please follow the instruction carefully to ensure the desired benefit of the device.

Step 1: Disassemble the cover by unscrewing all screws in SI no 1, thread in the cable adjuster of the Easy Clutch cable SI no 2 and Fig-A to reach max free play in the cable.

Step 2: Relax the cable adjuster 1 on the clutch lever yoke Fig-C you may also relax the adjuster ref Fig –D lock nut part 2 to facilitate release of the cable from the yoke.

Step 3: Now slide the OE cable head towards the right of the housing and locate the cable through the adjuster SL no 5.

Step 4: Slide the head of the Easy Clutch cable on to the clutch yoke and place the cable through the OE adjuster 1 on the yoke. Thread out the adjuster by about 50% threads on the housing side of Easy Clutch cable Fig-B.

To adjust the clutch:

- Turn the adjuster on the right side adjuster of the Easy Clutch housing until the correct amount of clutch lever free play ref Fig -E is achieved at all steering angles.
- If correct adjustment cannot be made using the adjuster in the housing, use the cable adjuster at the lower end of the cable by losing lock nuts 1 Fig-F.

Use the cable tie to fasten the clutch cable as appropriate.

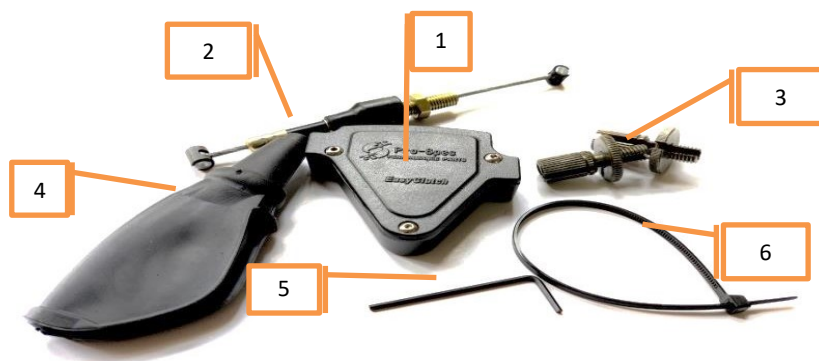

Sl.	DESCRIPTION	Part Number	QTY.
1	Housing	PS-CM/B03-01	1
	M3 Screws	PS -BO/EC-002	3
	Housing cover plate	PS-CM/B03-02	1
	Set of Fulcrum with bearing, Roller,PTFE washer	PS -F/B03 B	1
2	Easy Clutch Cable	PS -CM/B03-05	1
3	Adjuster	PS -BO/EC-003	1
4	Dust boot for lever end	PS -BO/EC-001	1
5	2 MM Allen key		1
6	Cable tie	PS -BO/EC-005	1

⚠ CAUTION

If the clutch lever has excessive free play, the clutch may not disengage fully. This will cause difficulty in changing gear and selecting neutral. This may cause the engine to stall and make the motorcycle difficult to control. Conversely, if the clutch lever has Insufficient free play the clutch may not engage fully, causing the clutch to slip, which will reduce performance and cause premature clutch wear. Clutch lever free play must be checked to meet specification.

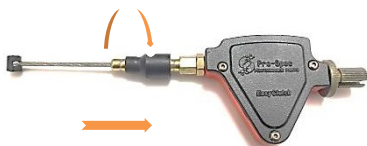

Fig -A

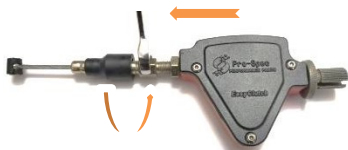

Fig -B

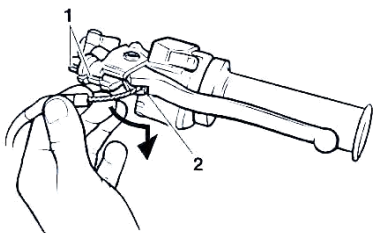

Fig -C

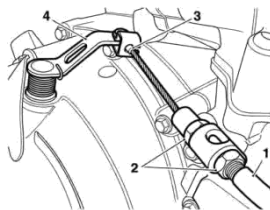

Fig -D

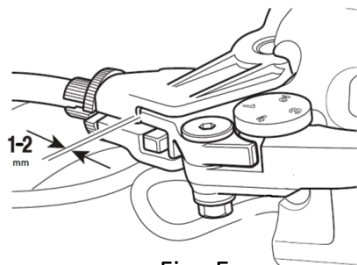

Fig -E

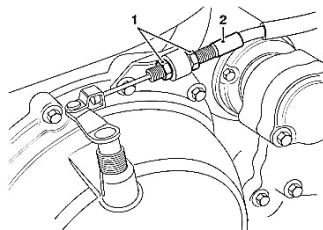

Fig -F



Note: Lubricate the OE cable using WD 40 or alternate cable lubricant.



Pro-Spec

Performance parts

No 14 Orchid, 6/5 Ganga Garden,
HM Road, Kalyan Nagar,
Bangalore -560043,
Karnataka, INDIA.
+91 95355 51133
+91 96204 84111
contact@prospec.co.in
www.prospec.co.in